

TEXTON



BASICS

WINDOW SHADINGS

Effective February 3, 2020

design simplified™

TABLE OF CONTENTS

Product Overview

- Features & Benefits 3
- Collection Information (includes Light Control) 4

Pricing Groups

- Pricing Group 1 (Translucent). 5
- Pricing Group 2 (Light Dimming) 6

Product Specifications

- Product Specifications and Finished Dimensions 7
- Options and Additional Notes 8
- Standard Shading Operation 9
- Motorization Overview 10-11
- Product Components. 12-14

Oversize Common Carrier Delivery

All orders with any quantity of shades or blinds or any continuous valance 96" or more in width are considered oversize. Therefore, a net shipping charge of \$45 per oversized unit will be assessed.

Oversized orders that require expedited shipping will be quoted and charged accordingly.

Please see General Information for additional freight and shipping charge information.

FEATURES & BENEFITS



- Offered in the popular 2-1/2" vane size, ideal for any size window.
- Streamlined collection featuring both translucent and light-dimming vane styles to provide varying degrees of light control.
- Available with one of the two new motorization systems
 - Simplicity Rechargeable: Rechargeable RF motorization system provides months of use between charges (with normal use). The rechargeable battery is hidden in the rotating rail meaning no external battery pack. Solar recharge option available.
 - PowerWand: The ease of Simplicity motorization with the convenience of remote free operation. Lift and lower the shading with the touch of a button on the pendant that hangs from the front of the headrail. The rechargeable battery is charged using the charging port in pendant.
 - > To suit your customer's needs the black or white colored wand is available in one foot increments from one to five feet and can be placed on either the left or right.
- Limited Lifetime Warranty ensures your customers' satisfaction.

COLLECTION INFORMATION

Family Name	Color Name	Family Code	Color #	Coordinating Hardware Color Name	Light Control	Price Group
Dynamic 2-1/2" Translucent	Aspen	DYSS	335	White	B	1
	Confection	DYSS	333	White	B	1
	Mystic	DYSS	331	White	B	1
	Pencil Sketch	DYSS	330	White	B	1
	Poppyfield	DYSS	334	White	B	1
	Tailwind	DYSS	332	White	B	1
Mistral 2-1/2" Translucent	Bay Leaf	MTSS	300	Evening Light	B	1
	Casual White	MTSS	304	White	B	1
	December Gray	MTSS	305	Silver Gray	B	1
	Prailine	MTSS	303	Vanilla	B	1
	Sailcloth	MTSS	302	Vanilla	B	1
	Wildflower	MTSS	301	Vanilla	B	1
Pergola 2-1/2" Translucent	Butter Cream	PGSS	315	Vanilla	B	1
	Canvas	PGSS	313	Vanilla	B	1
	Cobblestone	PGSS	310	Silver Gray	B	1
	Cotton Field	PGSS	311	White	B	1
	Honey Beige	PGSS	314	Vanilla	B	1
	Spring Snow	PGSS	312	White	B	1
Repose 2-1/2" Light Dimming *	Cloud White	RPSS	325	White	C	2
	Peaceful	RPSS	322	Vanilla	C	2
	Sandrift	RPSS	323	Vanilla	C	2
	Sesame	RPSS	324	Vanilla	C	2
	Shadow	RPSS	320	Silver Gray	C	2
	Twilight	RPSS	321	White	C	2

* Light Dimming fabrics provide category C, opaque light control because even when the vanes are completely closed they DO NOT completely seal off all incoming light.

See vane closure diagram on page 8 for a visual reference.

Note: Collections are presented alphabetically. Within each collection colors are also arranged alphabetically



A. Glare Reducing

Softly filters light and reduces glare. Images, shapes and people can be seen clearly. Provides the least amount of light and shape screening.



B. Filtering

Filters strong light. Images, shapes and people can be seen with some clarity. Provides a modest degree of light and shape screening.



C. Shading

Significantly reduces light. Images, shapes and people cannot be seen clearly. Provides a moderate to strong degree of light and shape screening.



D. Blocking

Dramatically reduces light. Images, shapes and people are not distinguishable. Provides privacy against most all direct light and shape screening (except minimal light that may seep through closed or overlapping opaque/blackout vanes).



E. Blackout

Blocks out virtually all light (except light that may enter on the sides of the shade) for maximum privacy and darkness.

2-1/2" Translucent
Dynamic (DYSS)
Mistral (MTSS)
Pergola (PGSS)

GROUP 1

WIDTH TO:	24"	30"	36"	42"	48"	54"	60"	66"	72"	76"	84"	90"	96"	102"	109"	120"
HEIGHT TO:																
36"	\$476	536	596	656	714	780	834	896	1052	1114	1176	1238	1296	1378	1542	1684
42"	500	568	632	698	762	830	896	964	1122	1192	1258	1326	1390	1478	1652	1804
48"	532	598	672	740	812	884	962	1034	1196	1268	1338	1410	1482	1572	1758	1920
54"	552	630	706	786	864	942	1020	1108	1266	1344	1420	1502	1586	1682	1888	2060
60"	580	664	744	824	906	1002	1088	1178	1334	1422	1506	1600	1692	1804	2030	2216
66"	604	696	784	870	964	1056	1158	1254	1406	1504	1602	1702	1798	1924	2172	2372
72"	632	728	820	914	1016	1122	1226	1328	1482	1588	1692	1798	1904	2038	2304	2514
78"	650	750	852	958	1058	1170	1276	1390	1552	1668	1776	1890	1994	2142	2424	2646
84"	676	784	886	1004	1114	1230	1348	1466	1634	1756	1872	1988	2102	2256	2556	2790
90"	704	812	926	1050	1170	1296	1416	1538	1712	1836	1966	2086	2210	2368	2684	2928
96"	732	848	964	1096	1226	1350	1480	1610	1790	1924	2056	2186	2314	2488	2818	3074
102"	836	968	1100	1244	1376	1500	1676	1840	1968	2102	2238	2364	2496	2654	2994	3268
108"	880	1018	1158	1308	1446	1580	1760	1940	2070	2210	2354	2492	2628	2794	3154	3444
114"	932	1082	1228	1390	1540	1680	1870	2058	2200	2352	2496	2640	2784	2962	3340	3648
120"	1004	1158	1318	1488	1642	1798	2002	2202	2354	2514	2674	2826	2982	3170	3576	3906

STANDARD FEATURES

- Headrail Size: 3-5/8" x 3"
- Snap-in Bracket Style
- Cord Tilt & Lift
- Color-Coordinated Hardware

OPTIONS: NO CHARGE – SPECIFY ON ORDER

- Fabric Headrail Insert
- Tilt Only
- Control Positions (R or L)
- Spacer Blocks
- Hold-Down Brackets
- Two-On-One Headrail – price as 2 separate shades (Standard Cord Loop Only)

OPTIONS: EXTRA CHARGE

- Cordless Lift. add \$110 per shading

MOTORIZATION OPTIONS: EXTRA CHARGE

- Simplicity Rechargeable Motor add \$398 per shading
 (Charging port available on the right side only)
 – 5 Channel Remote Control
 (Black Part #CS5138 or White Part #CS5138W) add \$58 each
 – Solar Panel (Part #CS52096) add \$218 each
- PowerWand add \$160 per shading
 – PowerWand Options (must be specified):
 1) Control Side (Left or Right)
 2) Wand Color (Black or White)
 3) Wand Length:
 1 foot (12")
 2 feet (24")
 3 feet (36")
 4 feet (48")
 5 feet (60")
- Plug-in Charger (Can be used for both Simplicity Rechargeable and PowerWand) (Part #CS5199) add \$44 each

SIZE STANDARDS	Standard Cord Loop	
	Single Shade	2-on-1 Headrail
Minimum ordered width	12"	24"
Minimum ordered width – tilt only	6"	N/A
Maximum ordered width	120"	120"
Maximum ordered width – tilt only	11-7/8"	N/A
Minimum ordered height	16"	16"
Maximum ordered height – translucent	120"	120"

SIZE STANDARDS	Cordless Lift	Simplicity Rechargeable	PowerWand™
Minimum ordered width	18"	19"	21"
Minimum ordered width – tilt only	NA	N/A	N/A
Maximum ordered width	84"	120"	120"
Maximum ordered width – tilt only	NA	N/A	N/A
Minimum ordered height	16"	16"	16"
Maximum ordered height – translucent	84"	120"	120"

GROUP 2
**2-1/2" Light Dimming
 Repose (RPSS)**

WIDTH TO:	24"	30"	36"	42"	48"	54"	60"	66"	72"	76"	84"	90"	96"	102"	109"	120"
HEIGHT TO:																
36"	\$526	592	658	724	788	858	918	988	1156	1228	1296	1364	1426	1516	1702	1856
42"	552	630	696	768	842	914	988	1056	1238	1310	1384	1458	1530	1622	1812	1978
48"	584	658	740	812	896	974	1056	1134	1310	1392	1472	1550	1630	1728	1938	2116
54"	608	692	780	864	944	1034	1122	1214	1390	1480	1562	1654	1748	1852	2082	2274
60"	638	728	818	908	1002	1098	1202	1296	1468	1562	1660	1760	1862	1982	2230	2434
66"	666	760	864	962	1056	1166	1272	1382	1546	1654	1764	1870	1978	2118	2390	2610
72"	696	798	904	1004	1120	1238	1346	1458	1630	1748	1864	1978	2088	2240	2566	2800
78"	714	822	938	1052	1166	1292	1406	1530	1708	1832	1958	2078	2196	2356	2752	3006
84"	744	864	974	1098	1228	1352	1484	1610	1798	1930	2058	2306	2410	2508	2952	3222
90"	776	896	1016	1152	1290	1422	1558	1690	1878	2018	2270	2408	2512	2668	3098	3382
96"	886	1016	1150	1296	1424	1552	1706	1862	2092	2222	2356	2490	2620	2800	3250	3548
102"	1016	1162	1310	1472	1598	1722	1932	2128	2296	2430	2564	2690	2822	2992	3452	3768

STANDARD FEATURES

- Headrail Size: 3-5/8" x 3"
- Snap-in Bracket Style
- Cord Tilt & Lift
- Color-Coordinated Hardware

OPTIONS: NO CHARGE – SPECIFY ON ORDER

- Fabric Headrail Insert
- Tilt Only
- Control Positions (R or L)
- Spacer Blocks
- Hold-Down Brackets
- Two-On-One Headrail – price as 2 separate shades (Standard Cord Loop Only)

OPTIONS: EXTRA CHARGE

- Cordless Lift..... add \$110 per shading

MOTORIZATION OPTIONS: EXTRA CHARGE

- Simplicity Rechargeable Motoradd \$398 per shading
 (Charging port available on the right side only)
 – 5 Channel Remote Control
 (Black Part #CS5138 or White Part #CS5138W) ... add \$58 each
 – Solar Panel (Part #CS52096)add \$218 each
- PowerWandadd \$160 per shading
 – PowerWand Options (must be specified):
 1) Control Side (Left or Right)
 2) Wand Color (Black or White)
 3) Wand Length:
 1 foot (12")
 2 feet (24")
 3 feet (36")
 4 feet (48")
 5 feet (60")
- Plug-in Charger (Can be used for both Simplicity Rechargeable and PowerWand) (Part #CS5199)add \$44 each

SIZE STANDARDS	Standard Cord Loop	
	Single Shade	2-on-1 Headrail
Minimum ordered width	12"	24"
Minimum ordered width – tilt only	6"	N/A
Maximum ordered width	120"	120"
Maximum ordered width – tilt only	11-7/8"	N/A
Minimum ordered height	16"	16"
Maximum ordered height – light dimming	102"	102"

SIZE STANDARDS	Cordless Lift	Simplicity Rechargeable	PowerWand™
Minimum ordered width	18"	19"	21"
Minimum ordered width – tilt only	N/A	N/A	N/A
Maximum ordered width	84"	120"	120"
Maximum ordered width – tilt only	N/A	N/A	N/A
Minimum ordered height	16"	16"	16"
Maximum ordered height – light dimming	84"	102"	102"

PRODUCT SPECIFICATIONS

FEATURES

# of fabric styles	4
# of colors	24
Headrail size	3-5/8" x 3"
Bracket style	Snap-in
Cord loop tilt and lift	Yes
Safety cord tensioner	Color Coordinated
Warranty	Limited Lifetime

OPTIONS

Two-on-One Headrail Option (Std Cordloop ONLY) not available with Cordless Lift or Motorized systems	Yes
Cordless Lift	Yes
Control positions	Left or Right
Fabric Headrail Insert	Yes
Hold-down brackets	Yes
Spacer blocks	Yes
Tilt Only (Standard Cordloop ONLY)	Yes
Specialty shapes	No
Tile cut-out	No
Cord Loop Drop	Yes

MOTORIZATION OPTIONS

Simplicity Rechargeable	Yes
- Remote	Black or White
- Plug-in Charger	Yes
- Solar Panel Charger	Yes
PowerWand Motorization (Rechargeable)	Yes
- Wand Length	1, 2, 3, 4, 5 feet
- Wand Color	Black or White
- Wand Position	Left or Right
- Plug-in Charger	Yes

CORD LOOP LENGTH

Translucent		Light Dimming	
Ordered Length	Cord Length	Ordered Length	Cord Length
16" to 19-7/8"	12"	16" to 19-7/8"	12"
20" to 26-7/8"	18"	20" to 26-7/8"	18"
27 to 39-7/8"	24"	27 to 39-7/8"	24"
40" to 59-7/8"	36"	40" to 59-7/8"	36"
60" to 83-7/8"	48"	60" to 83-7/8"	48"
84" to 107-7/8"	60"	84" to 102"	60"
108" to 120"	72"		

MOUNTING REQUIREMENTS

INSIDE MOUNT	
Minimum casement depth*	1-1/2"
Minimum casement depth*, fully recessed	3-3/4"
Minimum rear fabric clearance	1/8"

OUTSIDE MOUNT	
Minimum mounting surface height	3-1/8"
Recommended width overlap per side	3"
Minimum rear fabric clearance	1/8"

FINISHED DIMENSIONS

NOTE: WIDTH AND HEIGHT MAY VARY ± 1/8"

INSIDE MOUNT – Standard Deductions		
	Standard Cord Loop	
	Single Shade	2-on-1 Headrail
Headrail unit	1/8" less than ordered width	1/8" less than ordered width
Fabric width	1" less than ordered width	1" less than ordered width
Shading height	1/8" less than ordered height	1/8" less than ordered height
Fabric Gap	N/A	3/8"
OUTSIDE MOUNT – Standard Deductions		
	Standard Cord Loop	
	Single Shade	2-on-1 Headrail
Headrail unit	ordered width	ordered width
Fabric width	3/4" less than ordered width	3/4" less than ordered width
Shading height	1/8" less than ordered height	1/8" less than ordered height
Fabric Gap	N/A	3/8"

INSIDE MOUNT – Standard Deductions			
	Cordless Lift	Simplicity Rechargeable	PowerWand™
Headrail unit	1/8" less than ordered width	1/8" less than ordered width	1/8" less than ordered width
Fabric width	3/4" less than ordered width	1-1/8" less than ordered width	1" less than ordered width
Shading height	1/8" less than ordered height	1/8" less than ordered height	1/8" less than ordered height
OUTSIDE MOUNT – Standard Deductions			
	Cordless Lift	Simplicity Rechargeable	PowerWand™
Headrail unit	ordered width	ordered width	ordered width
Fabric width	5/8" less than ordered width	1" less than ordered width	3/4" less than ordered width
Shading height	1/8" less than ordered height	1/8" less than ordered height	1/8" less than ordered height

OPTIONS

FABRIC HEADRAIL INSERT

Features a coordinating fabric inserted into the front of the headrail to provide a soft fabric look from top to bottom.
(See surcharge on pricing pages)

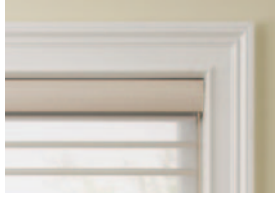

SIDE-BY-SIDE VANE ALIGNMENT

When window shadings are installed side by side, vane alignment can be guaranteed within 1/4" only if:

- Shadings are ordered at the same time and in the identical style, color and height.
- Shadings that need to be aligned are specified on the order form (a note must be included in Special Instructions).

ADJACENT SHADINGS

To span wide window openings, window shadings may be installed adjacently, so their headrails abut. The gap between the fabric panels of the adjacent shadings varies according to the control placement, as shown in the table below.

CONTROL PLACEMENT	
Adjacent (Abutting)	Window Shadings
Left/Right Shadings	Center Gap
Right/Right Controls	3/4"
Left/Left Controls	3/4"
Right/Left Controls	1-1/16"
Left/Right Controls	1/2"
Window shadings are not recommended for bay windows or butt-and-pass applications.	

ADDITIONAL NOTES

SHADING ADJUSTMENT

Shadings should wind evenly and not skew to one side.

A balance weight on the bottomrail can easily be adjusted if the fabric winds unevenly on the roll when the window shading is raised. Uneven winding can cause damage to the edge of the fabric.

- If skewing does occur:
 - Ensure headrail was installed level; shim if necessary.
 - To release, insert a flat blade screwdriver into the weight lock and turn clockwise.
 - Adjust placement of weight in bottomrail, 1" at a time, toward side where fabric is gathering.
 - Secure the weight locks in position by turning them counter clockwise, after making the adjustment.
 - Raise shade, then lower, if necessary, adjust again.

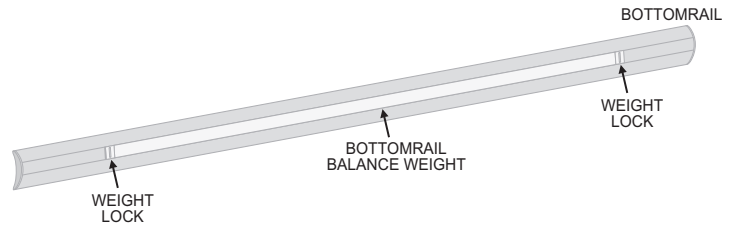

MAGNETIC HOLD-DOWN BRACKETS

Magnetic hold-down brackets secure the bottom of the shading to prevent swaying. Available upon request. Standard on tilt-only shadings.

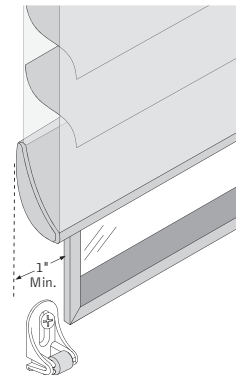

STANDARD SHADING OPERATION

STANDARD SHADING OPERATION

Referring to the illustration below.

- 1) Shading in fully raised position.
- 2) Pull down on rear half of the cord loop to lower shading and open fabric vanes.
- 3) Pull down on front half of the cord loop to close vanes and raise shading.

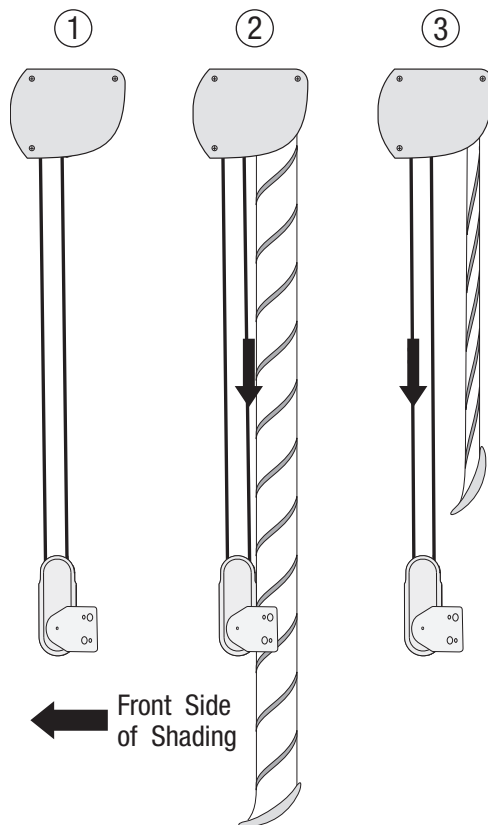

Light Control

With the shading in the fully lowered position, the cord loop is used to adjust the fabric vanes from open to closed, and anywhere in between. Light control is at your customer's fingertips. (Note: The degree of maximum vane closure varies slightly from the top to the bottom of the shading.)

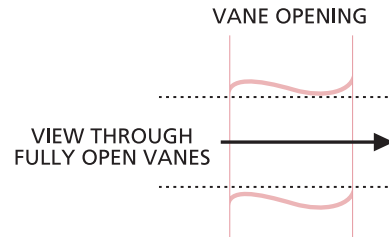

Vane Opening

Vane opening is the amount of unobstructed visibility between fully open vanes when looking through the shading at eye level. Vane opening for shadings is up to 1-1/4".

Vane Closure

When the vanes of a window shading are closed, they overlap each other, blocking the view. However, the vanes do not contact each other along the full length of the shading – they do not form a perfect seal against light leakage. This is most visible toward the bottom of the shading.

Vane closure is measured as the distance between the front and rear fabric facings 6" up from the lowest point of the bottomrail, with the shading fully lowered and the vanes closed, as illustrated here. Vane closure is 5/8" for shadings under 96" in height and 7/8" for shadings over 96" in height.

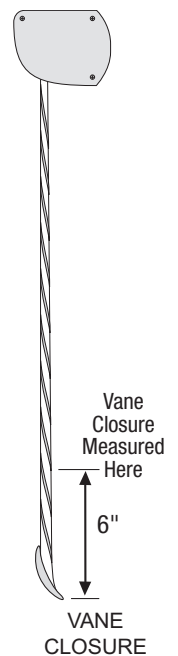

PLEASE NOTE: Cord tensioner MUST be mounted to window casement or wall in order for the shade to operate.

Cordless Operation

To Lower The Shade

- Pull down on the tassel until the shade is at the desired height.

To Raise The Shade

- Gently pull down on the tassel. To raise the shade completely, simply release the tassel and the shade will roll up fully into the headrail. To raise the shade partially, when the shade is at the desired height, gently pull on the tassel to stop the shade from raising.



Optional cordless lift control only

SIMPLICITY RECHARGEABLE MOTORIZATION: OVERVIEW

Simplicity Rechargeable

- The Rechargeable Simplicity motor program features an integrated rechargeable lithium ion battery in the motor casing and is fully concealed by the inner tube.
- Rechargeable battery is included with the motor. The average battery charge will last 6-12 months based on an average sized shade raised and lowered once per day. The life of the battery charge will vary based on the type of window covering selected, the size and weight of the window covering and the number of times the shade is operated on a daily basis. The battery can be recharged up to 500 times. It takes approximately 5 hours to recharge the motor when fully depleted. Charging port available on the right side only.

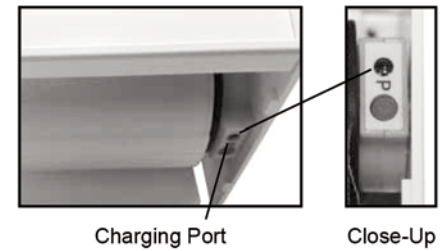

Battery Charger

- An 8.4 Volt charger requires a standard power outlet to recharge the battery. The charger must be specified when ordering Simplicity Rechargeable Motorized shade option. The charger plugs into the charging port of the motor. The charger is black and comes with a 156" wire. The dimensions are 1" wide x 2-1/2" length x 1-3/4" deep. Sold separately.



Solar Panel Recharge Option

- Plugs in to any Simplicity Rechargeable motorized shading (does not work with PowerWand). Provides constant trickle charge to 7.4v Li-ION Rechargeable battery packs. Does not require direct sunlight, but performs best in regular direct sunlight applications. Will prolong the life of the charge of the 7.4v rechargeable battery packs, and in some applications will maintain charge indefinitely.
- Life of charge is subject to application variables such as size and weight of shade, frequency of use, amount of direct sunlight exposure, etc.



Dimensions of panel
18½" x 1½"

5 Channel Remote

- The remote can operate up to five shadings simultaneously, individually or in groups. Remotes and holders are available in white or black. The remote comes with a holder which can be mounted to a wall for easy storage. The range of the remote is approximately 80 feet.



Please Note:

- Not all motors run at the same rate of speed.
- Simplicity motors have a "Favorites" position setting. To set a "Favorites" position, follow instructions provided in the installation instructions.

POWERWAND MOTORIZATION: OVERVIEW

PowerWand™ Motorization

- Shadings can be fabricated with the PowerWand Rechargeable Push Button Control option. The PowerWand Rechargeable option is an easy, cord free motorized operation for the budget savvy homeowner. PowerWand Rechargeable uses Simplicity motors and components.

PowerWand Rechargeable Shades Operation

- Press the up or down button on the pendant to raise or lower the shading to your desired position. No programming is required with PowerWand as upper and lower limits are set at the factory. If desired, upper and lower limits can be adjusted in the field.
- Please refer to the installation instructions for instructions on resetting the upper and lower limits and setting a favorites position can be programmed on-site.

PowerWand Appearance

- The PowerWand Rechargeable wand and pendant is attached to the head rail and requires no additional mounting.
- The wand and pendant hangs down the front of the shades from the head rail.
- Pendant is 2-1/2" long.
- The pendant does not need to be mounted to the wall to operate the shade.

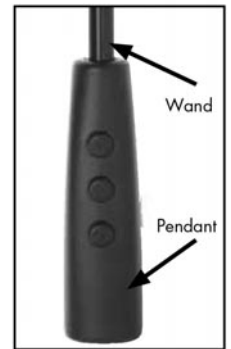

PowerWand Options

- Wand is available in Black or White (there is no default)
- Wand is available in 1 foot increments from 1 to 5 feet (there is no default)
- Wand is available on either the right or left side of the shade (there is no default)



PowerWand Battery Life

- The battery life will vary based on the type of window covering selected, the size and weight of the window covering and the number of times you operate the blind on a daily basis.

Battery Charger

- 8.4 Volt charger requires a standard power outlet to recharge the battery. The charger must be specified when ordering the PowerWand motorization option. The charger plugs into the charger port on the side of the pendant. The charger is black and comes with a 156" wire. The dimensions are 1" wide x 2-1/2" length x 1-3/4" deep.



PRODUCT COMPONENTS – STANDARD

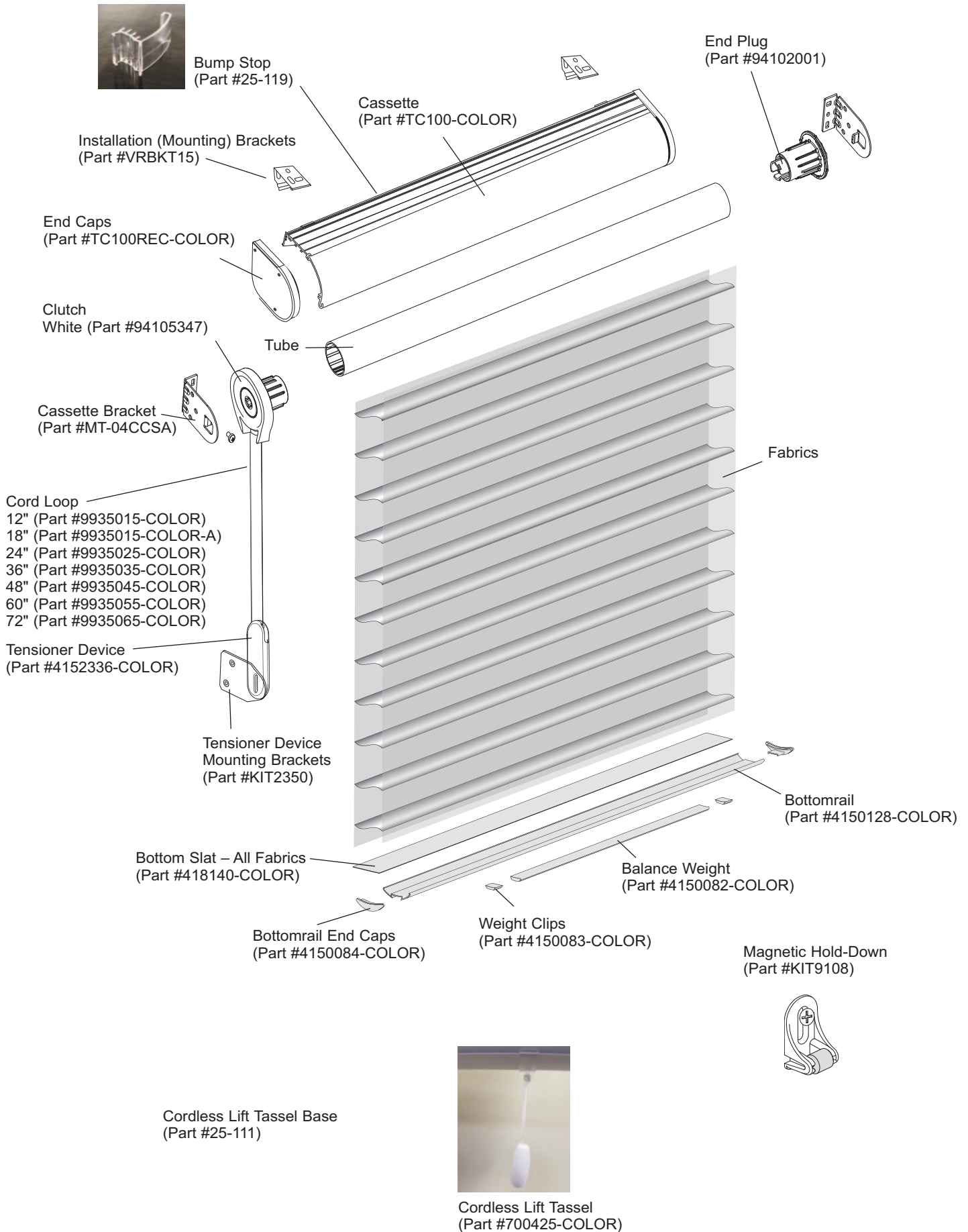

PRODUCT COMPONENTS – SIMPLICITY RECHARGEABLE MOTORIZATION

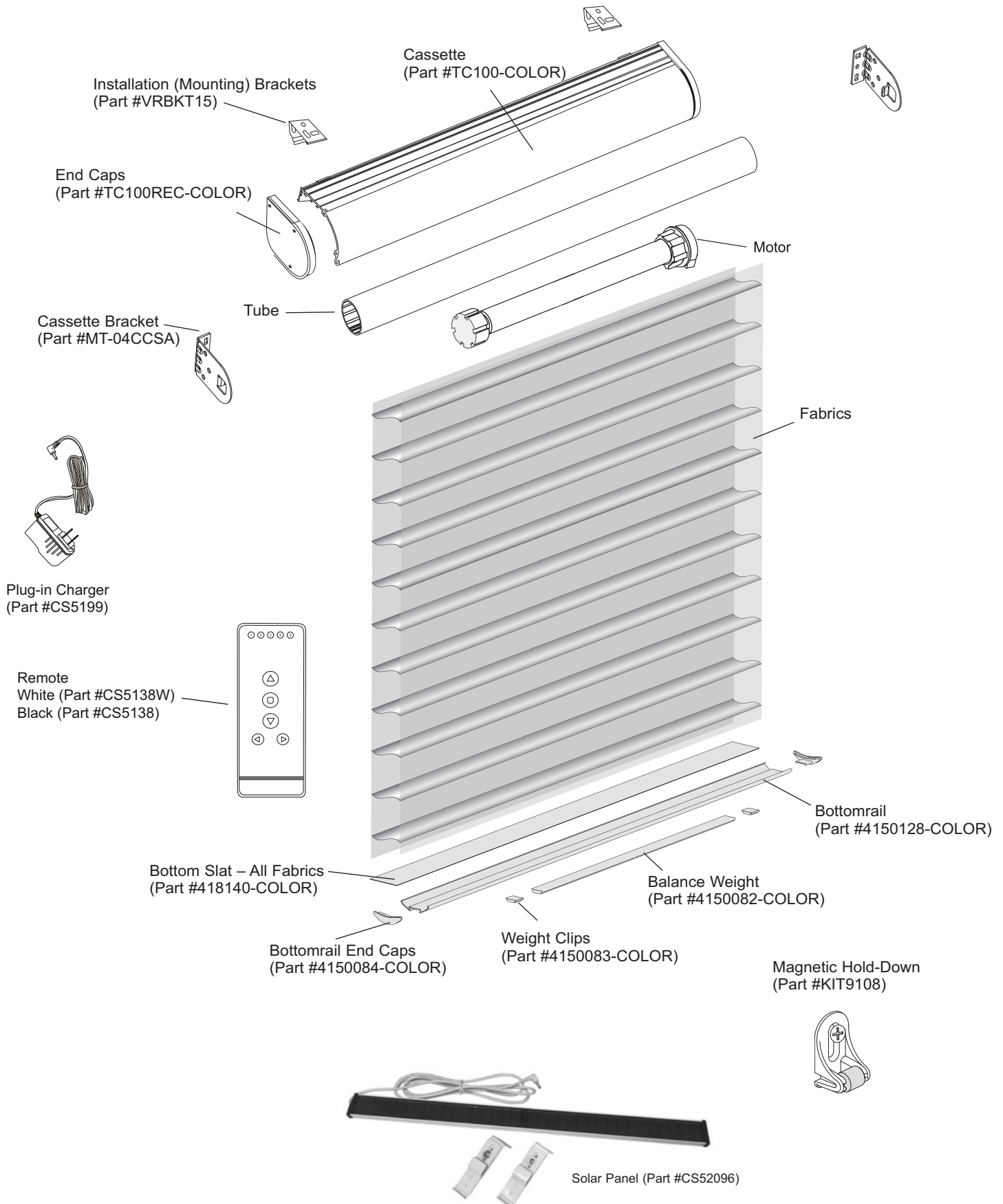

PRODUCT COMPONENTS – POWERWAND MOTORIZATION

